



11/35 Meadow Crescent Meadowbank NSW

2 1 1

Nestled peacefully at the rear of the complex, this first-floor two-bedroom unit is neatly presented and is ready to occupy or lease out straight away.

For those looking to add their own touches, there is scope to modernise the kitchen & bathroom either now or in the future to transform the space into your dream home. Located just minutes' walk from Meadowbank Train Station, Ferry Wharf, Village Bay Plaza and Meadowbank Reserve, it's no wonder that this address is such a popular location to call home.

Property Highlights |

- First-floor unit set in a security building
- Two bedrooms of accommodation with a large built-in wardrobe and an east-facing window to the main
- Combined lounge & dining with adjacent balcony
- Neat and tidy kitchen with electric cooking appliances

Price : \$ 590,000

View : <https://www.awardgroup.com.au/sale/nsw/northern-suburbs/meadowbank/residential/unit/7917589>



Leighton Avery
(02) 9808 1199

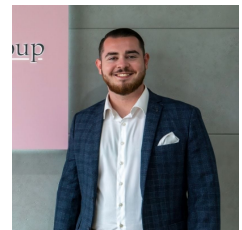

Lochlan McDermott
(02) 9808 1199



AwardGroup
REAL ESTATE

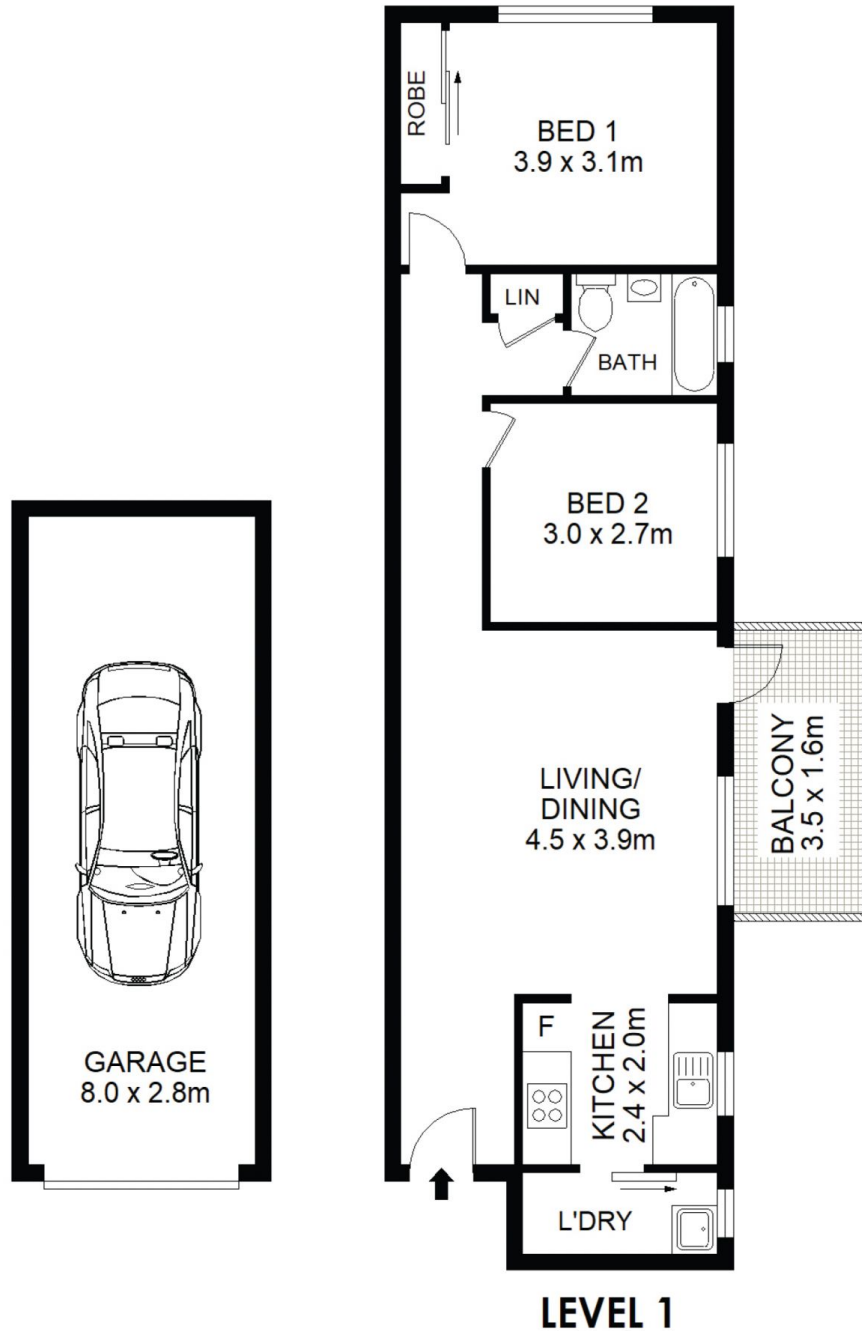

11/35 Meadow Crescent Meadowbank



DISCLAIMER: DIMENSIONS ARE APPROXIMATE AND SHOULD ONLY BE USED AS A GUIDE. THEY ARE NOT TO SCALE AND NO LIABILITY BE ACCEPTED.