



20/18-18a Meadow Crescent Meadowbank NSW

2 1 1

Light-filled via North-western facing windows and with direct views over Meadowbank reserve, this renovated 2-bedroom unit comes complete with a lock up garage and internal laundry. Located within minutes' walk to Meadowbank Station and Ferry Wharf, it will also be a great option for those considering their daily commute.

View : <https://www.awardgroup.com.au/lease/nsw/north-ern-suburbs/meadowbank/residential/unit/7319019>

Property Highlights |

- Renovated kitchen with ample cupboard and bench space
- Well-proportioned living room, offset by North-facing glass sliding door and a large, top floor balcony
- Main bedroom with private balcony overlooking Meadowbank reserve
- North-facing second bedroom
- Stylish bathroom, tiled floor to ceiling | Complete with



Rentals Team
(02) 9808 1199

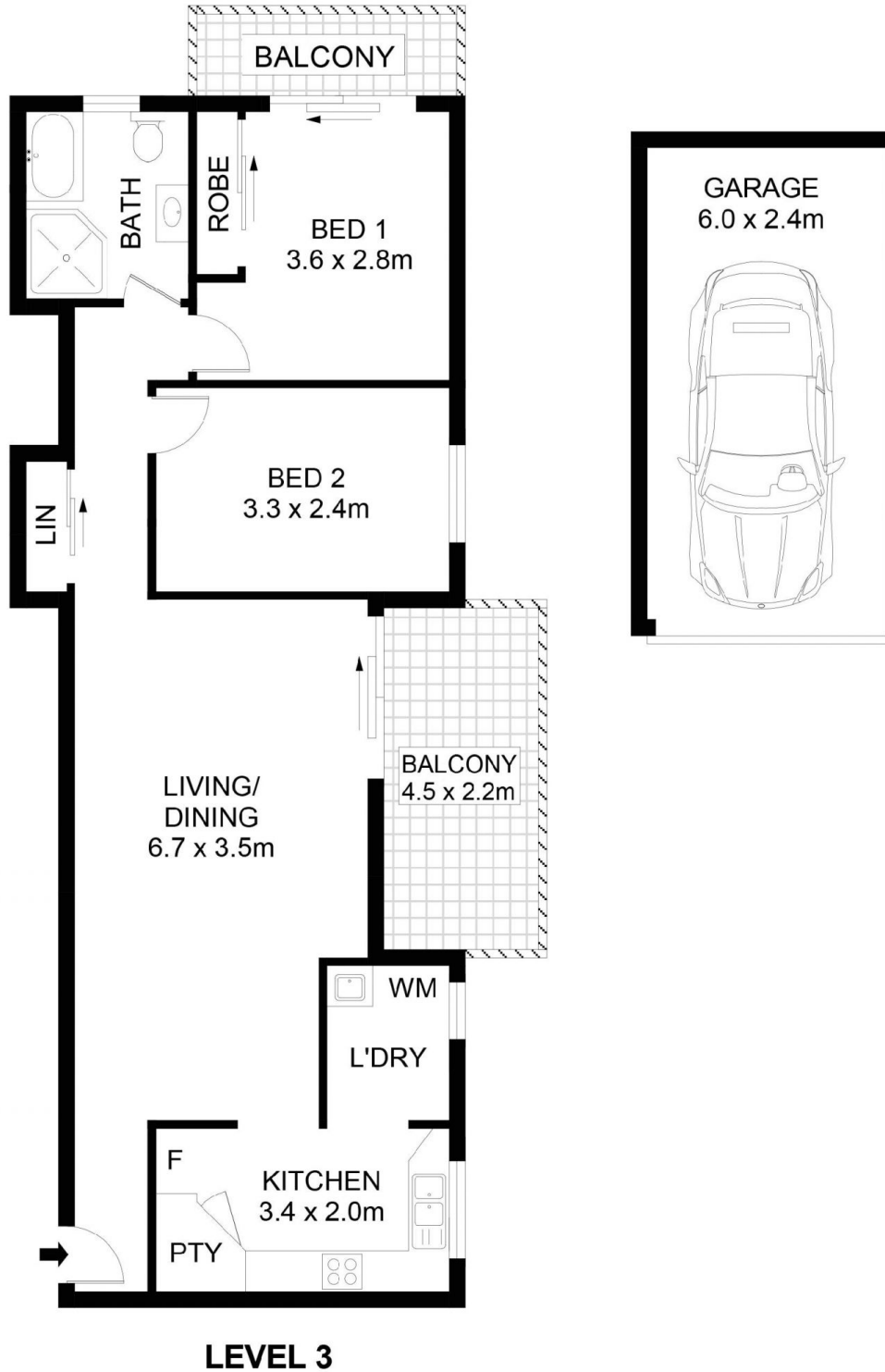

20/18-18a Meadow Crescent Meadowbank

