

### 9/12 Meadow Crescent Meadowbank NSW

2 1 1

Enjoying not only a short walk to Meadowbank train station, Ferry wharf and Village Plaza, this tastefully renovated unit encompasses the tranquillity that the tree top views of Memorial park and Meadowbank reserve have to offer. A combination of North and South facing windows ensures all rooms are consistently light filled and airy all year-round. Along with modern features and well-proportioned living spaces, you'll find no better place to call home than this solid double-brick unit.

#### Property Highlights:

- As new, gourmet kitchen with ceramic cooktop, stainless-steel oven, double sink and loads of cupboard and bench space that continues through to an internal laundry leading off the kitchen.
- Spacious lounge and dining room, light filled and offering

**Price** : \$ 662,000

**View** : <https://www.awardgroup.com.au/sale/nsw/northern-suburbs/meadowbank/residential/unit/6100893>

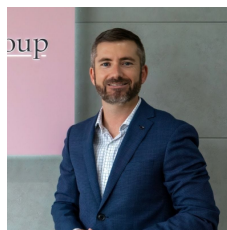

**Leighton Avery**  
(02) 9808 1199



**David Johnson**  
(02) 9808 1199

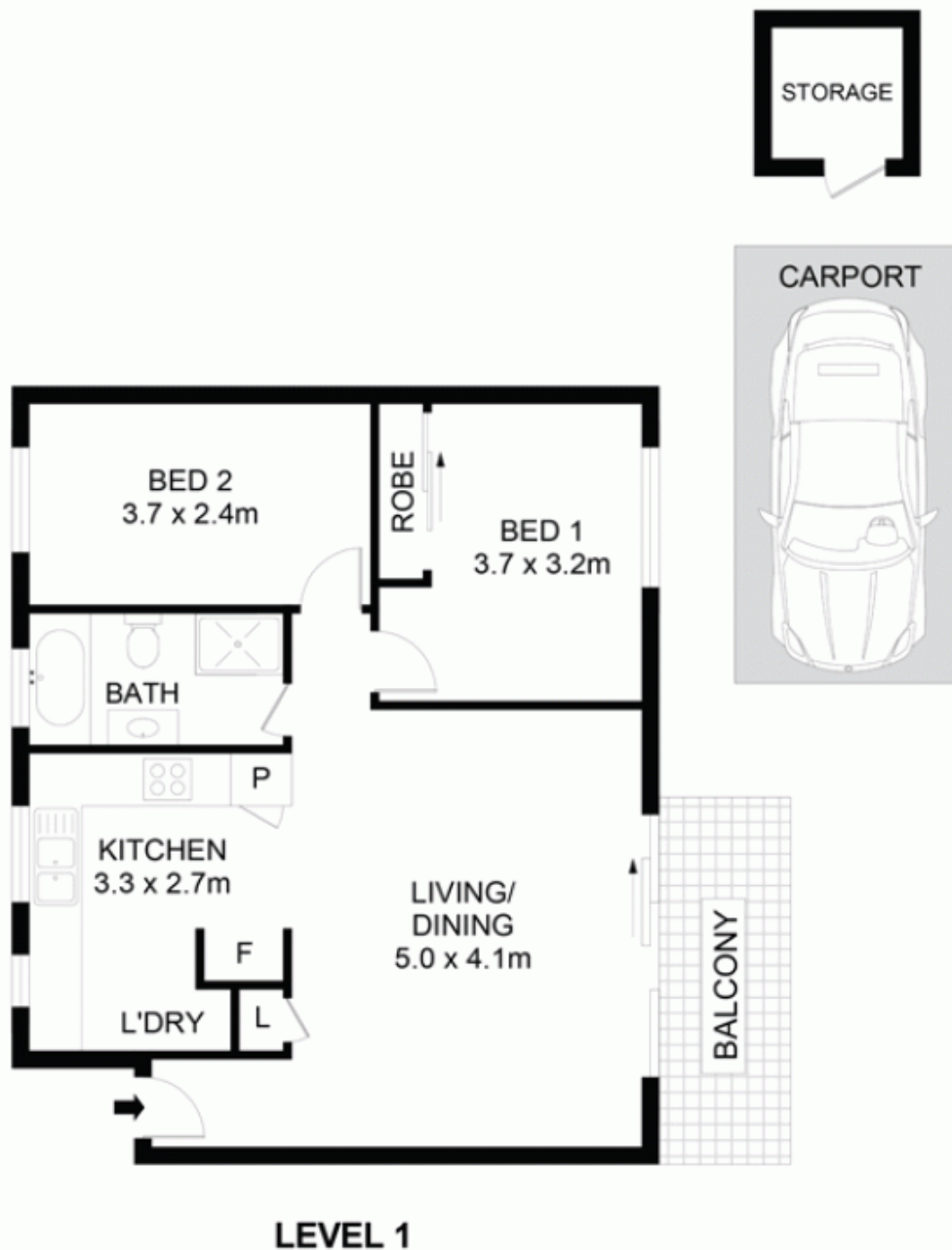

9/12 Meadow Crescent Meadowbank



DISCLAIMER: DIMENSIONS ARE APPROXIMATE AND SHOULD ONLY BE USED AS A GUIDE. THEY ARE NOT TO SCALE AND NO LIABILITY BE ACCEPTED.