



23/11 Pearce Street Ermington NSW

2  2  1 

Nestled in a peaceful and private setting, this impressive townhouse showcases contemporary appointments throughout, an abundance of living space, and boasts bright interiors. It is conveniently located within 7-10 minutes of Eastwood, is between the Parramatta CBD and Ryde precinct, and offers easy access to transport, schools, shops and parks.

Boasting house-like proportions with generous front and rear yards, this property is sure to suit a vast array of prospective purchasers including downsizers and first home buyers alike.

Do yourself a favour and join us at an upcoming inspection?

Property Highlights |

Price : \$ 768,000

View : <https://www.awardgroup.com.au/sale/nsw/parra-matta/ermington/residential/townhouse/5277360>



David Johnson
(02) 9808 1199



Leighton Avery
(02) 9808 1199



GROUND LEVEL

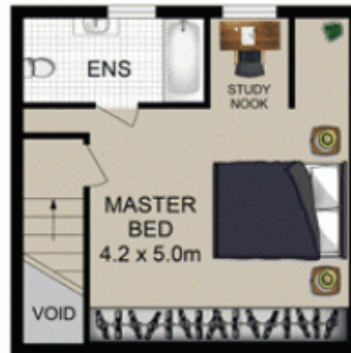

FIRST LEVEL

23/11 Pearce Street Ermington



DISCLAIMER

DIMENSIONS ARE APPROXIMATE AND SHOULD ONLY BE USED AS A GUIDE
THEY ARE NOT TO SCALE AND NO LIABILITY WILL BE ACCEPTED

AwardGroup
Real Estate